

Project Case Study

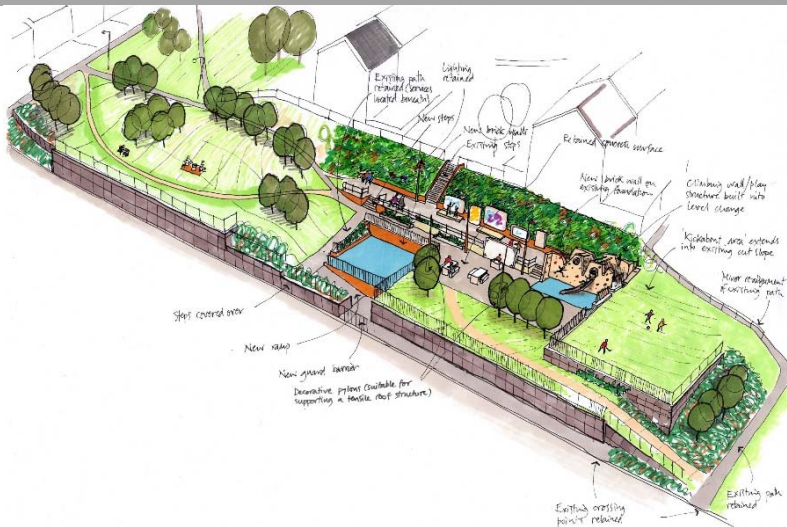

Newtown Community Park

In 2014 a regeneration scheme was developed from a community consultation exercise to provide an area of parklands and play facilities for children.

The innovative scheme was specially designed to encapsulate asbestos from the previous brownfield area at Newtown Housing Estate in Ebbw Vale.

Griffiths were appointed to carry out the works on this restricted site, which involved excavating the asbestos cement waste and encapsulating it in four cells lined with high visibility geotextile membrane.

Works involved:

- Use of existing site voids as basis for encapsulation of contaminated material
- Retaining walls constructed from stone-faced mesh gabions
- Contaminated material encapsulated in woven geotextile and capped with clean material
- Re-use of bow top railings, foundations built into gabion walls
- Borrow pit excavated on the site to generate volumes of clean, suitable capping material (from beneath existing concrete slab)

The scheme has provided a clean site for a community park and playground with cost savings of £50k. This was achieved through the encapsulation method of the asbestos which avoided any hazardous waste leaving site.

The project was completed with zero complaints received and no reportable accidents.



Project Details:

Client

Tai Calon Housing

Location

Ebbw Vale

Completion Date

December 2017

Value

£290k

Contract

JCT

Key Project Aspects

- Innovative Remediation
- Encapsulation of Contaminated Material/Asbestos
- Retaining Walls
- Value Engineering
- All Material Retained on Site
- Sustainability